

# YOUR MACHINE OUR PRIORITY

**Our machine concept turns  
machining on its head!**

**Surprisingly good at finding solutions  
problem parts and production difficul-  
ties! Curious?**



**Find out more and  
discover efficient  
solutions:**

**Watch here**

## FM 3+X

First choice for small and medium-sized components made of light metals and steels (illustration with pallet conveyor belt and coolant system)

## FM 3+X *hd*

The best solution for heavy-duty machining processes in steel, forging, cast iron or other difficult materials

## FM 4+X *hd*

Guarantees the best performance for medium-sized and large components, even in difficult-to-cut materials

# WE MAKE MACHINES

We supply custom machining centers, special-purpose machinery, and manufacturing modules tailored to your needs. Many industries, including large bearing manufacturers, automotive OEMs, and their suppliers, rely on our experience and expertise in developing and implementing highly productive machining processes. We specialize in designing and manufacturing primarily cutting machine tools and turnkey solutions.

ELHA machines and our manufacturing solutions are highly productive, process-safe, and durable. Our enthusiastic professionals guide every step of your planned investment journey, extending well beyond the commissioning phase.

## ELHA-MASCHINENBAU Liemke GmbH & Co. KG

**Plant 1**  
Allee 16  
33161 Hövelhof

Phone: 05257 / 508-0  
E-mail: [info@elha.de](mailto:info@elha.de)

**Plant 2**  
Otto-Hahn-Straße 27  
33161 Hövelhof

**Do you have  
questions?  
Contact us!**

V2

[www.elha.de](http://www.elha.de)



## Production Modules & Transfer Centers

<https://www.elha.de/en/machines/production-modules/>

# Variety in size, solutions that fit:

...for small to medium-sized workpieces

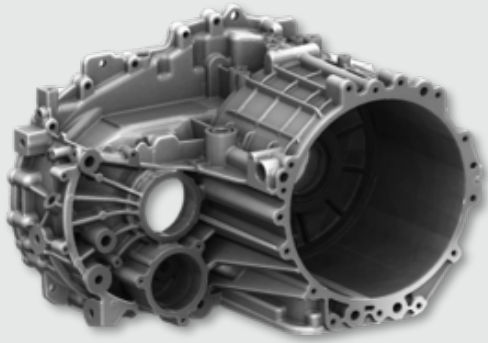

E-motor housing

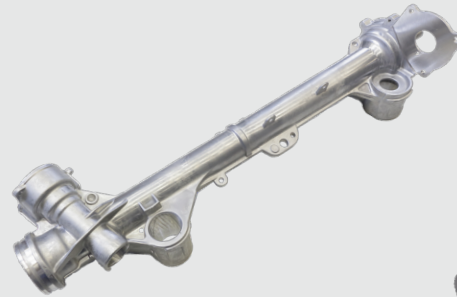

Steering housing



Stator shafts

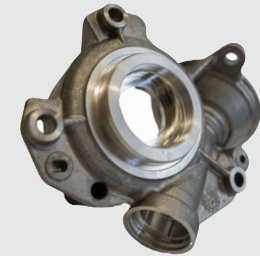

Worm gear housing

PRODUCTIVITY

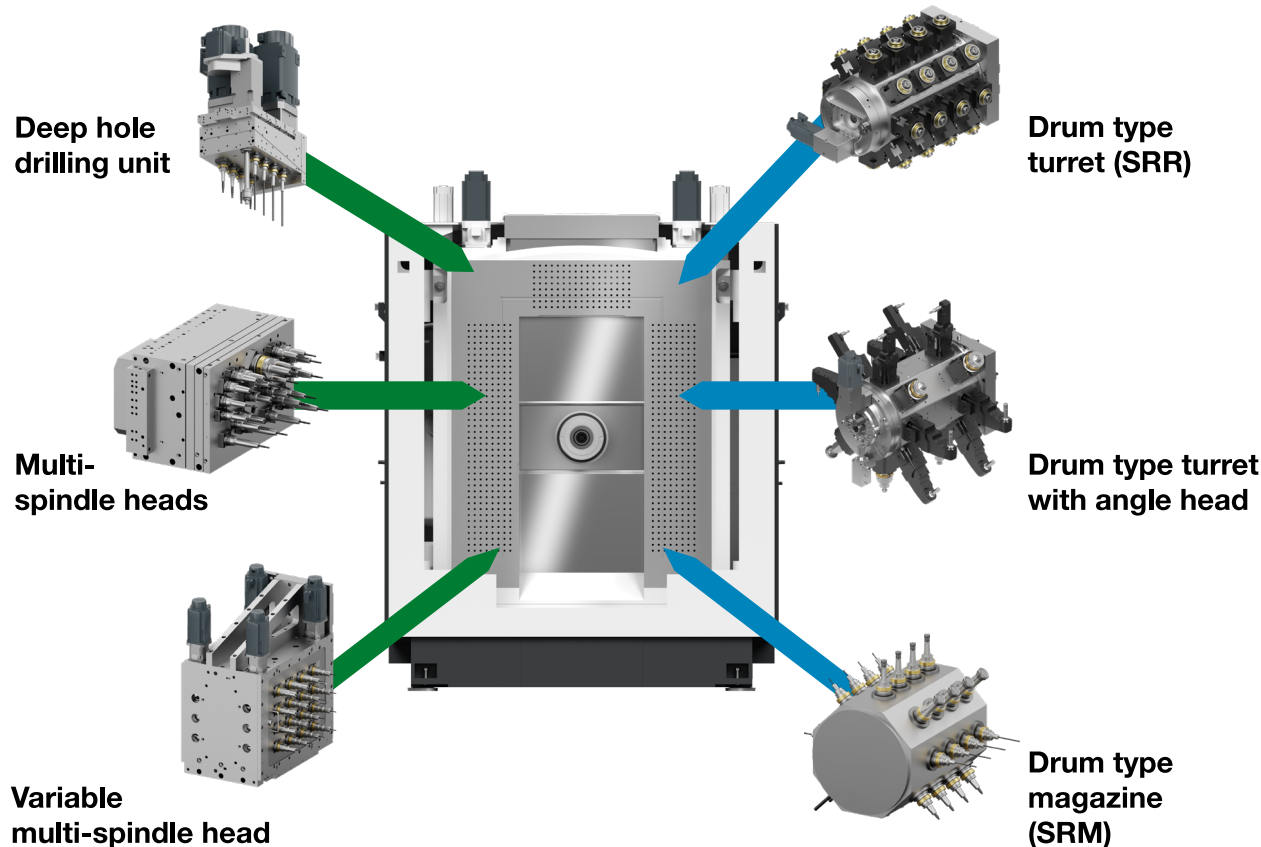

FLEXIBILITY

**Our modules: Freely configurable, limitless possibilities**

## MAXIMUM PRODUCTIVITY

through the exclusive use of process-optimised multi-spindle heads and special units

## MAXIMUM FLEXIBILITY

for 4-spindle machining with up to 40 different tool types

**It's the combination that makes the difference**

Combining the best of productivity and flexibility, together we will find the right **turnkey solution** for you!

Ready for maximum efficiency? Discover our possibilities